

CS2050

| | |
|---------------------------------|-----|
| 1. Sorter [6803] | 7-2 |
| 2. Bin Motor Board [6803] | 7-4 |
| 3. Sorter Harness [6803] | 7-6 |
| Parts Index | 8-1 |

1. SORTER [6803]

July 31, '86

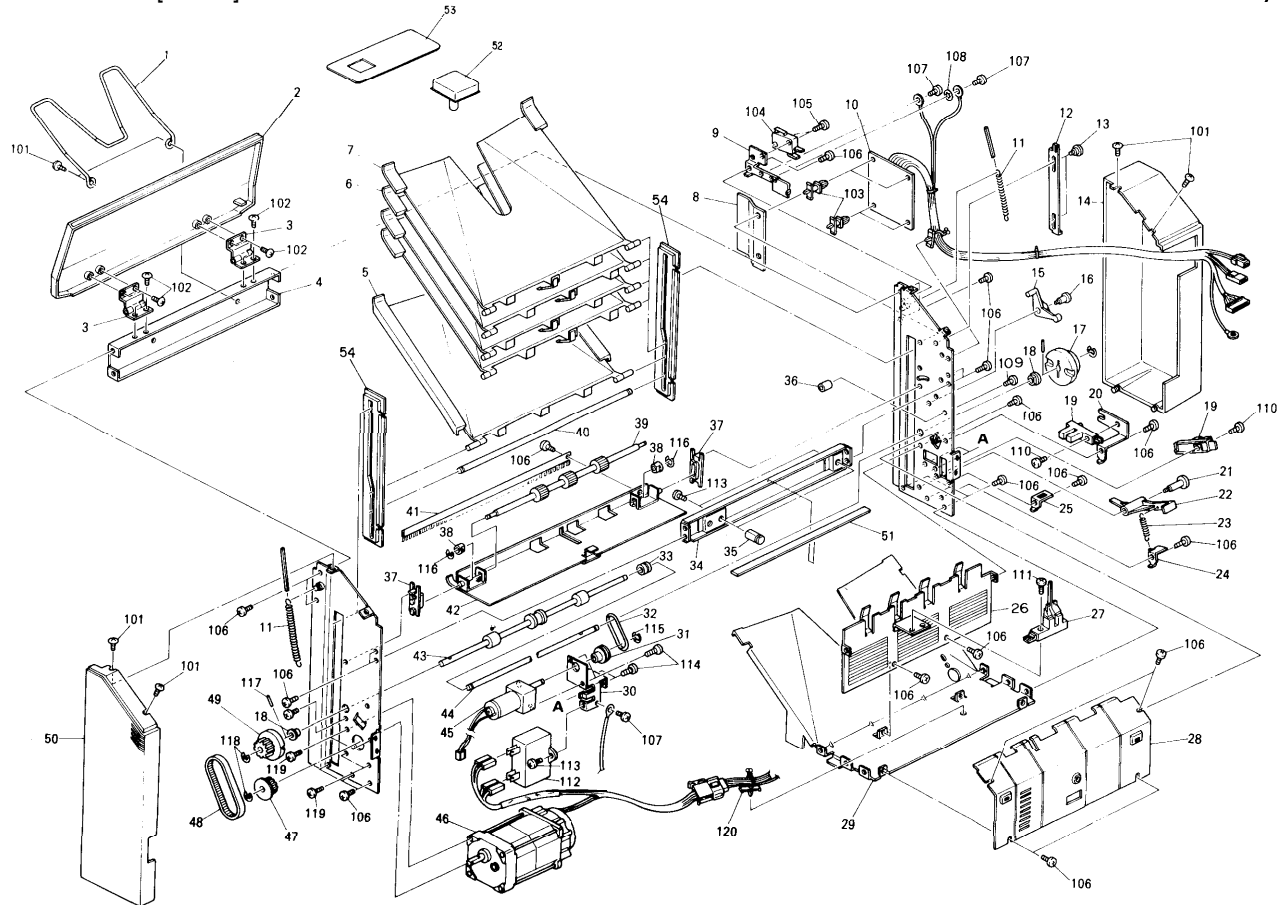

1. SORTER [6803]

July

| Index No. | Parts No. | Description | Q'ty Per Assembly |
|-----------|-----------|-------------------------------|-------------------|
| * | 68036613 | Multi-Lingual Decal | 1 |
| * | 68036517 | Installation Procedure - 115V | 1 |
| * | 68036527 | Installation Procedure - 220V | 1 |
| 1 | 59171641 | Original Holder | 1 |
| 2 | 68036311 | Upper Cover | 1 |
| 3 | 68031141 | Upper Support Plate | 1 |
| 4 | 68036911 | Hinge - Upper Cover | 2 |
| 5 | 68033211 | Sorter Bin - Bottom | 1 |
| 6 | 68033151 | Sorter Bin - Even | 10 |
| 7 | 68033111 | Sorter Bin - Odd | 10 |
| 8 | 68036411 | Insulating Plate | 1 |
| 9 | 68034431 | Bracket - Safety Switch | 1 |
| 10 | 68035500 | Bin Motor Board | 1 |
| 11 | 68033311 | Transfer Wheel Shaft | 2 |
| 12 | 68032271 | Lever - Upper Guide Plate | 1 |
| 13 | 54032075 | Stepped Screw | 2 |
| 14 | 68036211 | Rear Cover | 1 |
| 15 | 68032272 | Arm - Upper Guide Plate | 1 |
| 16 | 68032273 | Stepped Screw - M4 | 1 |
| 17 | 68033326 | Rear Transfer Wheel | 1 |
| 18 | 50530447 | Bushing - 6mm | 2 |
| 19 | 52055250 | L.E.D. Sensor Type S | 2 |
| 20 | 68033421 | Half Turn Sensor | 1 |
| 21 | 68033412 | Stepped Screw - M4 | 1 |
| 22 | 68033411 | Lever - Home Position Sensor | 1 |
| 23 | 68033413 | Lever Spring | 1 |
| 24 | 68033414 | Lever Stopper | 1 |
| 25 | 68034441 | Cover Bracket | 1 |
| 26 | 68032311 | Cover - Electrical Section | 1 |
| 27 | 68035430 | Paper Exit Sensor | 1 |
| 28 | 68032111 | Lower Guide Plate | 1 |
| 29 | 68031131 | Base Plate | 1 |
| 30 | 68034411 | Cover Bracket | 1 |
| 31 | 68034216 | Pulley | 1 |
| 32 | 68034316 | O-ring | 1 |

| Index No. | Parts No. | Description | Q'ty Per Assembly |
|-----------|-----------|------------------------------------|-------------------|
| 33 | 68032415 | Drive Pulley | 1 |
| 34 | 68031151 | Mounting Stay | 1 |
| 35 | 68031161 | Upper Mounting Stud | 2 |
| 36 | 68032261 | Dumper - Upper Guide Plate | 1 |
| 37 | 68032221 | Guide - Upper Guide Plate | 2 |
| 38 | 68032231 | Bushing - 4 x 6 x 5 mm | 2 |
| 39 | 68032241 | Upper Exit Roller | 1 |
| 40 | 68033316 | Lift Bar | 1 |
| 41 | 68032251 | Antistatic Brush | 1 |
| 42 | 68032211 | Upper Guide Plate | 1 |
| 43 | 68032410 | Lower Exit Roller | 1 |
| 44 | 68033331 | Transfer Wheel Shaft | 1 |
| 45 | 68035410 | Paper Exit Motor | 1 |
| 46 | 68035400 | Bin Motor - AC 14/17W | 1 |
| 47 | 68034211 | Pulley - 18T | 1 |
| 48 | 68034311 | Timing Belt - 94 x L | 1 |
| 49 | 68033321 | Front Transfer Wheel | 1 |
| 50 | 68036111 | Front Cover | 1 |
| 51 | 67691128 | Mounting Stay Magnet | 1 |
| 52 | 59184020 | Option Key Top | 1 |
| 53 | 68037512 | Sorter Key Cover - English | 1 |
| 53 | 68037513 | Sorter Key Cover - International | 1 |
| 54 | 68031115 | Slot Liner | 2 |
| 101 | 03340080D | Philips Sunken Head Screw - M4 x 8 | |
| 102 | 03140060W | Philips Pan Head Screw - M4 x 6 | |
| 103 | 11050162 | Locking Support | |
| 104 | 12041318 | MicroSwitch | |
| 105 | 03130140W | Philips Pan Head Screw - M3 x 14 | |
| 106 | 04340080W | Tapping Screw - M4 x 8 | |
| 107 | 03140080M | Philips Pan Head Screw - M4 x 8 | |

| Index No. | Parts No. | Description | Q'ty Per Ass |
|-----------|-----------|--|--------------|
| 108 | 07040040C | Toothed Washer - M4 | |
| 109 | 04340100W | Tapping Screw - M4 x 10 | |
| 110 | 03140120W | Philips Pan Head Screw - M4 x 12 | |
| 111 | 03130120W | Philips Pan Head Screw - M3 x 12 | |
| 112 | 16060755 | Capacitor - 10uF 220V (115V) | |
| 112 | 16061380 | Capacitor - 10uF (220/240V) | |
| 113 | 03140080W | Philips Pan Head Screw - M4 x 8 | |
| 114 | 09653010W | Tapping Screw With Flat Washer - M3 x 10 | |
| 115 | 07200040E | Retaining Ring - M4 | |
| 116 | 07200030E | Retaining Ring - M3 | |
| 117 | 06316140G | Parallel Pin | |
| 118 | 07200060E | Retaining Ring - M6 | |
| 119 | 03150080W | Philips Pan Head Screw - M5 x 8 | |
| 120 | 11050196 | Harness Clamp | |

%

-

2. BIN MOTOR BOARD [6803]

July 31, '86

SYMBOL NO. : PRINTED NUMBER ON THE BOARD
INDEX NO. : REFERENCE NUMBER OF NEXT PAGE

| CONNECTOR | | DIODE | | SSR | |
|------------|-----------|------------|-----------|------------|-----------|
| SYMBOL NO. | INDEX NO. | SYMBOL NO. | INDEX NO. | SYMBOL NO. | INDEX NO. |
| CN101 | 101 | 0101 | 106 | SSR101 | 105 |
| CN102 | 102 | 0102 | 106 | SSR102 | 105 |
| CN103 | 104 | | | | |
| CN104 | 103 | | | | |

2. BIN MOTOR BOARD [68031

July 31, '1

| Index No. | Parts No. | Description | Qty Per Assembly |
|-----------|-----------|------------------------------|------------------|
| * | 68035500 | Bin Motor Board | 1 |
| 101 | 11020995 | Connector - 2P | |
| 102 | 11021194 | Pin Connector - 3P | |
| 103 | 11031695 | Connector - 15P | |
| 104 | 11031748 | Connector - 12P | |
| 105 | 12081024 | Solid State Relay - 240V, 2A | |
| 106 | 14010832 | Diode - OSA1A1 | |

| Index No. | Parts No. | Description | Qty Per Assembly |
|-----------|-----------|-------------|------------------|
| | | | |

3. SORTER HARNESS [6803]

July 31, '86

